

ASSEMBLY & INSTALLATION INSTRUCTIONS

XO350, XO350R, XO500, XO500R, XO750

ASSEMBLY & MOUNTING:

Place the jockey wheel on the trailer drawbar as near to the coupling as convenient. Make sure that the jockey wheel does not interfere with other parts of the trailer or vehicle. Tighten all bolts evenly.

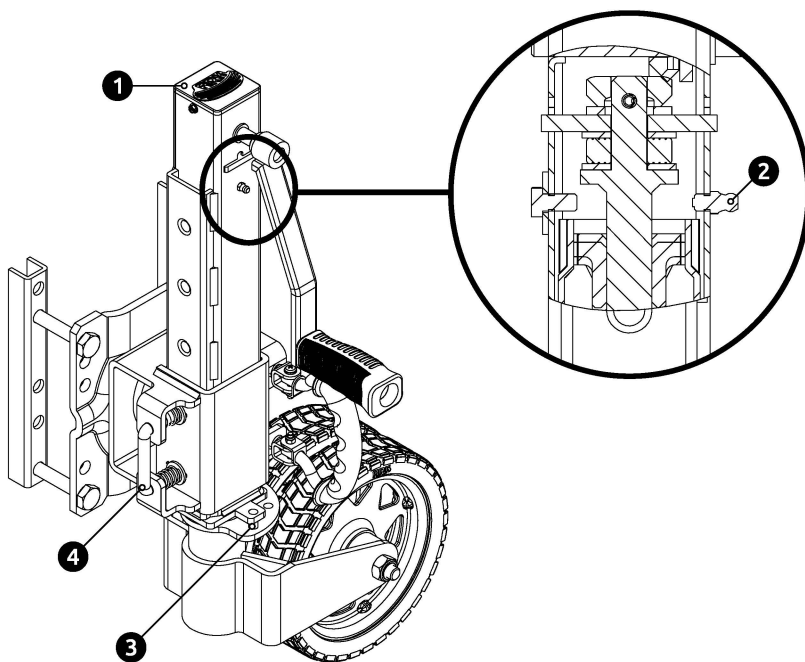

Note: jockey wheel fits 50mm (XO350, XO350R, XO500 only), 75mm, 100mm, 130mm & 150mm rectangular drawbars. Drawbars wider than 50mm require replacement of existing mounting bolts of appropriate length.



Loads in excess of rated capacity will cause accelerated wear on the jockey wheel parts and possible failure

OPERATION:

Cranking can be minimised by adjusting the height adjuster u-shaped pin **(4)** to the lowest setting possible before cranking. Be certain the yoke locking pin **(3)** is disengaged before jockey wheel can be manoeuvred. Raise trailer by cranking the jockey wheel anti-clockwise and lower by cranking clockwise.

When the jockey wheel reaches the end of its travel do not force handle. To do so will result in damage. When trailer is unhitched and stationary parked or during manoeuvring your trailer with weight on the jockey wheel, keep the jockey wheel cranked to the lowest possible position to avoid unnecessary strain. Before towing the trailer, be sure the jockey wheel is raised completely and wheel locked in a position to give maximum road clearance.



This jockey wheel is not for highway use. Never tow trailer with a load on the jockey wheel.

MAINTENANCE:

Minimal maintenance is required to keep your jockey wheel looking new and in good working order. Protect the finish by keeping it clean and periodically applying a coating of silicone lubricant spray. Lubrication is needed if the jockey wheel ever feels rough or produces a grinding noise when cranked.

With weight off the jockey wheel remove plastic cap **(1)** by removing cap retaining screw. Place a sufficient amount of grease on the bevel gears, crank jockey wheel handle to ensure an even amount of grease is distributed on the bevel gears. Replace plastic cap **(1)** and insert cap retaining screw. Using a grease gun, fill a sufficient amount of grease into the inner shaft of the jockey wheel through the grease nipple **(2)** located behind the crank handle. Crank the handle in a clockwise direction lowering the jockey wheel. This will distribute the grease and work the grease along the entire thread.

Note: If this jockey wheel is fitted to a boat trailer or off-road trailer that is subjected to constant immersion into salt water or water crossings then maintenance should be carried out more frequently.



Avoid cranking jockey wheel to an unnecessary height and avoid side loads on the jockey wheel that could cause damage or excessive wear.



ASSEMBLY INSTRUCTIONS

XO Series Jockey Wheel Range

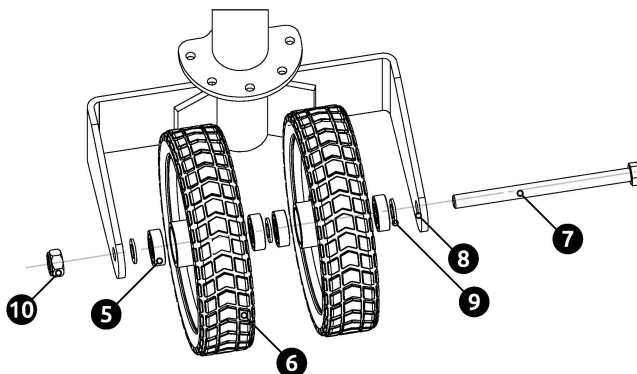

1. Insert one bearing **(5)** into each side of each wheel **(6)**.
2. Thread the bolt **(7)** through one of the holes of the yoke **(8)**
3. Place washer **(9)** onto the bolt **(7)** then a wheel - fitted with a bearing, while pushing the bolt through gradually as you add parts.
4. Place another washer for the center position followed by the second wheel - fitted with a bearing, onto the bolt
5. Place the last washer onto the bolt and thread the bolt all the way through the yoke's hole.
6. Secure the bolt and wheel mechanism with the nylock nut **(10)** provided but do not over-tighten, ensure the wheels rotate freely.

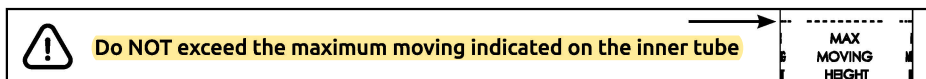

DRAW BAR OBSTRUCTION(S):

In the event that there is an obstruction on your drawbar that prevents the bolt being fitted from the direction **(A)** shown, it is acceptable also to insert the bolt from the opposite side **(B)** of the yoke.

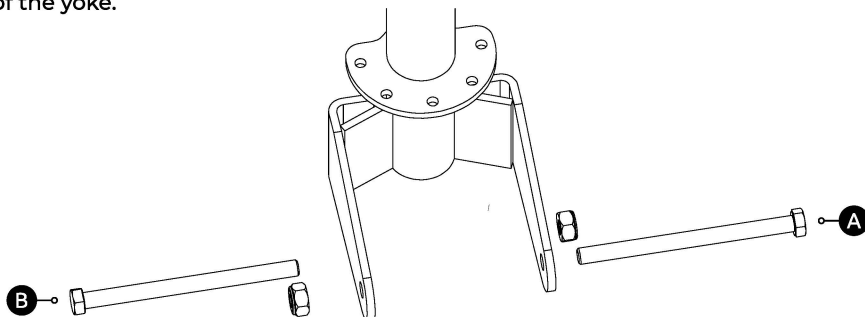



INSTALLATION TO DRAWBAR

XO Series Jockey Wheel Range

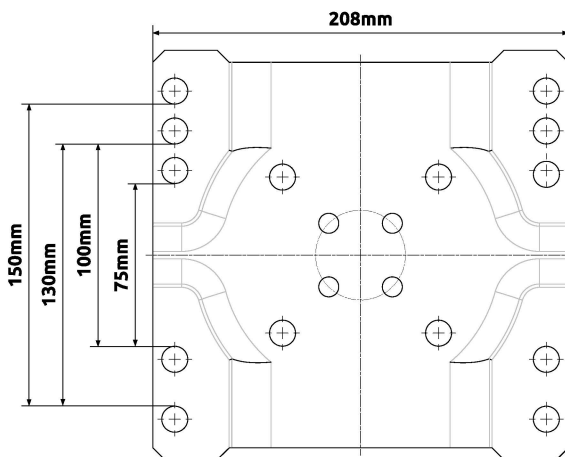

XO750/XO500R

Drawbar Fitment



DO NOT exceed 70nm of torque when tightening to trailer chassis

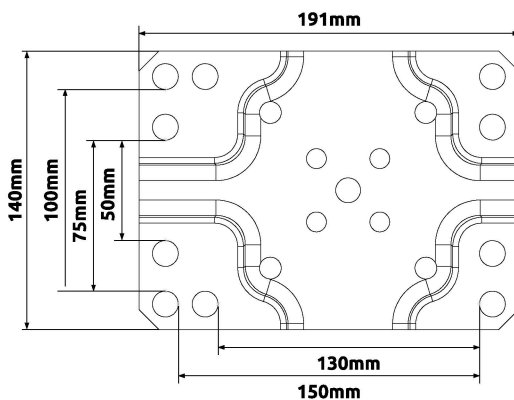

XO500 / XO350 / XO350R

Drawbar Fitment

US Patent Number 9,975,525
Australian Patent Number 2014203288
Canadian Patent Application Number 2 854 707



Ark Corporation Pty Ltd
8 Smoothy Place Arndell Park NSW 2148
sales@arkcorporation.com
www.arkcorporation.com