

Installation Instructions

GuardDogg®

GMC SIERRA/CHEVY SILVERADO 1500

(851305 – WHITE / 851360 – BLACK)

FORD F150, RAM 1500, GM 2500/3500

(851405 – WHITE / 851460 – BLACK)

RAM 2500/3500 (851505 – WHITE / 851560 – BLACK)

FORD F250/350 (851605 – WHITE / 851660 – BLACK)

IMPORTANT: Prior to installation, check owner's manual or contact your truck manufacturer for all necessary pickup box reinforcement kits. Always install recommended kits prior to window protector installation. Failure to follow this procedure may void truck's warranty. Never exceed recommended maximum combined weight of equipment and cargo, recommended by truck's manufacturer. Place installation instructions and warranty information in vehicle glove box after installation.

TOOLS REQUIRED:

- 7/16 Wrenches / Socket (2)
- 1/2 Wrench / Socket
- 9/16 Wrench / Socket
- Electric Drill



CAUTION

- Park your vehicle on flat, horizontal surface. Apply parking brake or use wheel chocks to prevent accidental rolling.
- To keep debris out of your eyes always wear protective eyewear.
- Tighten screws and nuts only when it is recommended by these instructions.
- Check contents of box against part list to ensure all components are included



WARNING

The third brake light must remain visible to those behind the vehicle. After installing the Guard Dogg, stand to the rear and sides of the vehicle and verify that the third brake light is still visible through the third brake light slot."

INSTALLATION

1. Remove the Mounting Brackets (Items 5 and 6) from the bottom of the Guard Dogg Screen Assembly.
2. The Guard Dogg Screen Assembly has two different widths: Standard (69") and Extended (71"). (See Figure 1). The Screen Assembly comes pre-assembled at the Standard width. To change the width of the Screen Assembly, remove the four sets of 1/4"-20 Screws (Item 12), 1/4" Flat Washers (Item 11), and

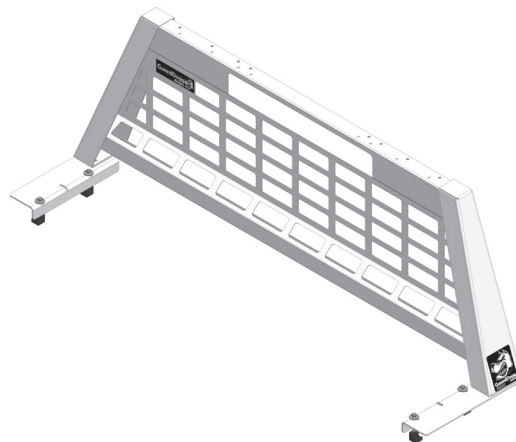

1/4"-20 Lock Nuts (Item 13) located on the rear of the Screen Assembly. Shift the Towers (Items 2 and 3) outwards so that the outer slots of the Towers align with the outer holes of the Screen (Item 1). Use the hardware to attach the Towers to the Screen. (See Figure 2). Tighten all Screws and Lock Nuts.

2. To attach the Mounting Brackets (Items 5 and 6) to the Screen Assembly, first place the Washer Plates (Item 4) in the gaps between the Screen and the base of the Towers so that the slots in the Washer Plate and base of the Towers align. (See Figure 3). Attach the Mounting Brackets to the base of the Towers using 5/16"-18 x 1 Carriage Bolts (Item 7a), 5/16" Flat Washers (Item 7c) and 5/16"-18 Lock Nuts (Item 7b). (See Figure 4). Tighten all Carriage Bolts and Lock Nuts. **NOTE: To determine which positioning holes in the Mounting Brackets to use, refer to Figure 5.**

3. Place the Screen Assembly on the front of the truck bed as close to the cab as possible. Clamp the Mounting Brackets to the truck bed using the Tie Down Kits (Item 10) provided. Secure the 5/16"-18 x 3-1/2 Screws, 5/16" Flat Washers, and Clamp Blocks in the front and rear slots in the Mounting Brackets. (See Figure 6). If there is no lip for the Clamp Block to catch onto in the slot nearest to the Screen Assembly, use the middle slot of the Mounting Brackets. Tighten all Tie Down Kits. Overtightening these Screws can result in damage to the truck bed walls.

4. Crossbody Installation: Measure and cut the 1/4" thick foam pads so that they can be placed along the length of the top of the Mounting brackets. (See Figure 7). Place the Crossbody onto the Mounting Brackets and open the top of the Crossbody. Align the rear mounting slots on each side of the inside of the Crossbody with the empty middle slots in the Mounting Brackets. If there are Tie Down Screws in the middle slots of the Mounting Brackets, then remove them and use them in place of the J-Bolts provided with the Crossbody. Measure the area beneath where the Crossbody extends beyond the Mounting Brackets and cut the 1/2" thick foam pads so that they can be placed along the length of the truck bed underneath where the Crossbody overhangs from the Mounting Brackets.

Fig. 1

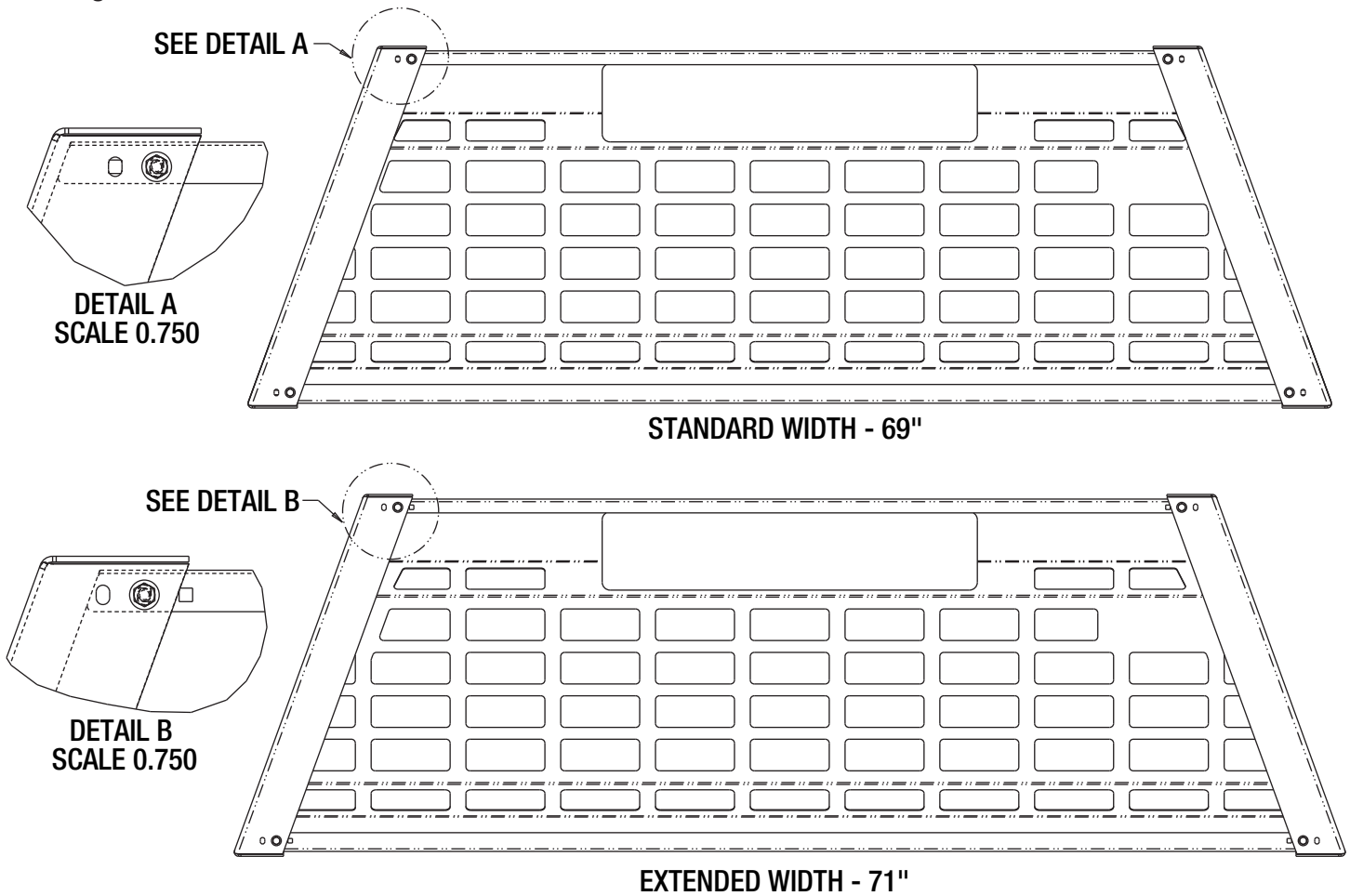

Fig. 2

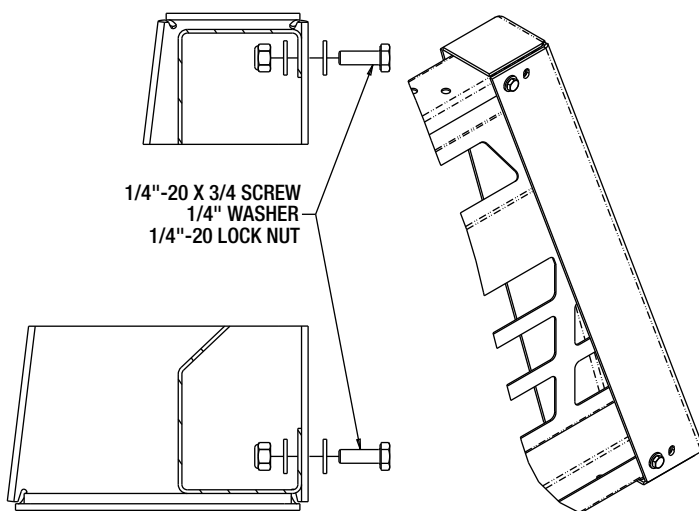
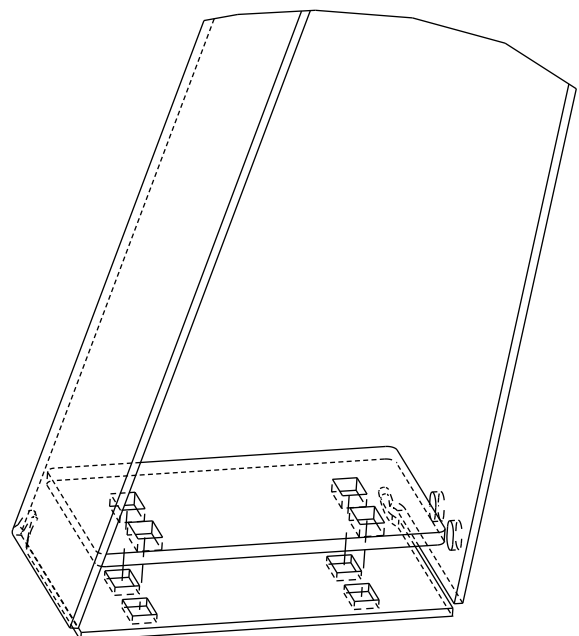

Fig. 3



ALIGN ALL FOUR SLOTS IN WASHER PLATE
WITH SLOTS IN TOWER BASE AS SHOWN

Fig. 4

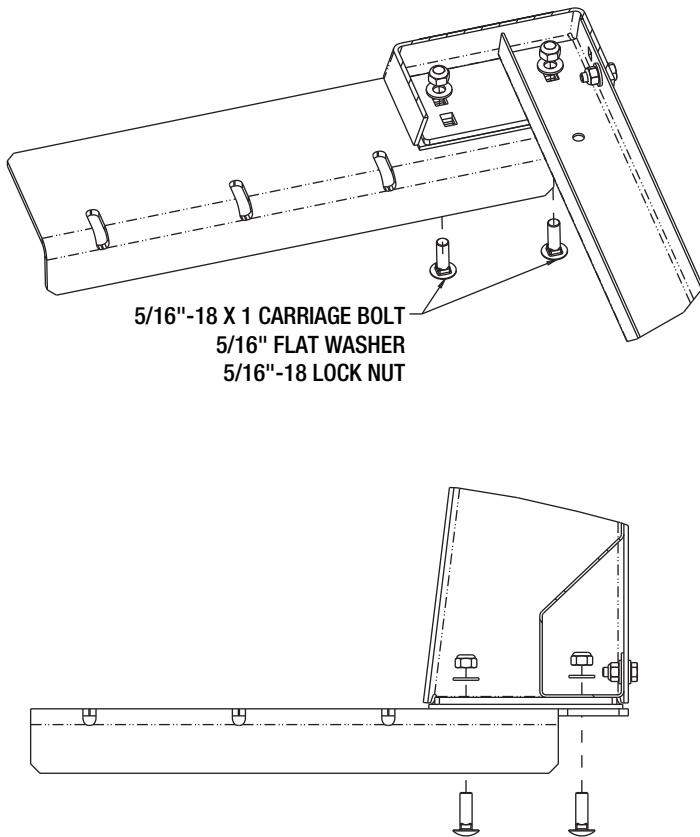
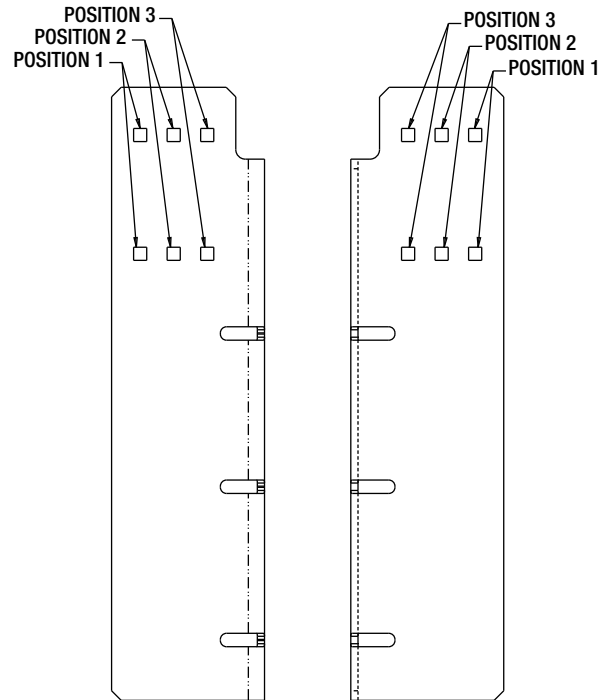

Fig. 5



MODEL	POSITION
FORD F150	2
FORD F250	3
FORD F350	3
RAM 1500	2
RAM 2500	3
RAM 3500	3

MODEL	POSITION
CHEVY SILVERADO 1500	2
CHEVY SILVERADO 2500	2
CHEVY SILVERADO 3500	2
GMC SIERRA 1500	2
GMC SIERRA 2500	2
GMC SIERRA 3500	2

Fig.6

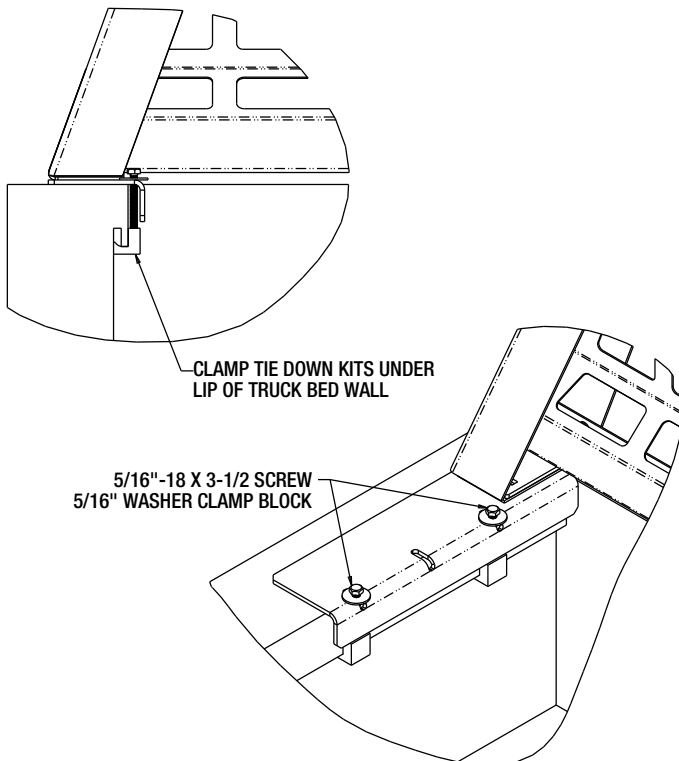
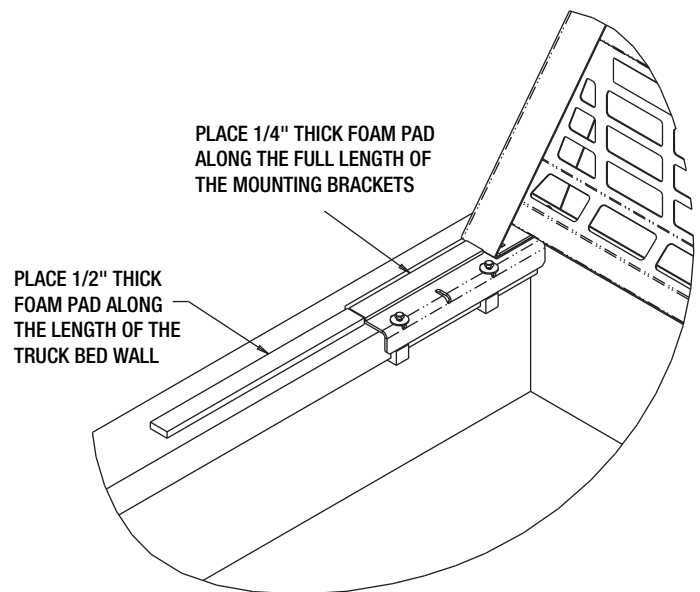
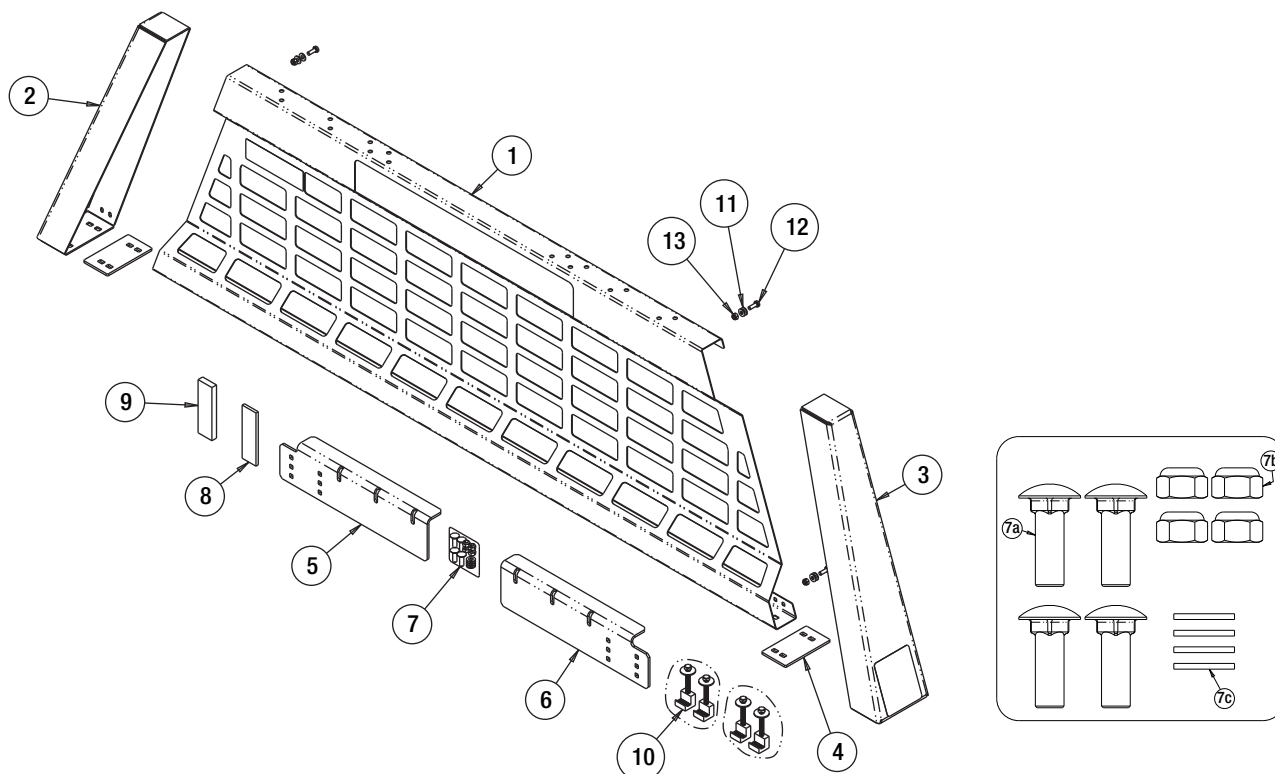

Fig.7



BILL OF MATERIALS

Each size and color have its own variant of the screens, towers, and brackets. Here are their part numbers.



ITEM	PART NO.	QTY.	DESCRIPTION	TOP LEVEL PART
1	3059215	1	SCREEN	851305
2	3061136	1	TOWER DS	
3	3061137	1	TOWER PS	
1	3061761	1	SCREEN	851405
2	3061759	1	TOWER DS	
3	3061760	1	TOWER PS	
1	3061208	1	SCREEN	851505
2	3061209	1	TOWER DS	
3	3061210	1	TOWER PS	
1	3061626	1	SCREEN	851605
2	3061627	1	TOWER DS	
3	3061628	1	TOWER PS	
1	3062339	1	SCREEN	851360
2	3062340	1	TOWER DS	
3	3062341	1	TOWER PS	
1	3062342	1	SCREEN	851460
2	3062343	1	TOWER DS	
3	3062344	1	TOWER PS	
1	3062345	1	SCREEN	851560
2	3062346	1	TOWER DS	
3	3062347	1	TOWER PS	

ITEM	PART NO.	QTY.	DESCRIPTION	TOP LEVEL PART
1	3062348	1	SCREEN	851660
2	3062349	1	TOWER DS	
3	3062350	1	TOWER PS	
5	3059630	1	BRACKET DS	BRACKET (WHITE)
6	3059629	1	BRACKET PS	
5	3062351	1	BRACKET DS	BRACKET (BLACK)
6	3062352	1	BRACKET PS	
4	3061624	1	WHITE	WASHER PLATE
4	3062390	1	BLACK	
7	3061227	1	HDW KIT, GUARDDOGG	
7A	3026934	4	BOLT, CARRIAGE, 5/16-18 X 1 SST	
7B	FNE031018034SS	4	NUT, NYLOCK, 5/16-18, SST WAX	
7C	FWF031075006SS	4	WASHER, FLAT, 5/16 X .688 X .065, SST	
8	3061595	2	PAD, FOAM, PROTECTOR, W/PSA, 1/4in THICK	
9	3061596	2	PAD, FOAM, PROTECTOR, W/PSA, 1/2in THICK	
10	1701052	2	TRUCK BOX TIE DOWN, UNIVERSAL, 2 PACK	
11	FWF025063007SS	8	WASHER, FLAT 1/4 SAE SS	
12	FCS025020075SS	6	SCREW, CAP 1/4-20 X 3/4 SST	
13	FNE025020031SS	6	NUT, NYLOCK, 1/4-20, SST WAX	

WARRANTY

Buyers Products Co. warrants all truck/trailer hardware manufactured or distributed by it, to be free from defects in material and workmanship for a period of one year from date of shipment. Parts must be properly installed and used under normal conditions. Any product which has been altered, including modification, misuse, accident or lack of maintenance will not be considered under warranty. Normal wear is excluded. The sole responsibility of Buyers Products Co. under this warranty is limited to repairing or replacing any part or parts which are returned, prepaid, and are found to be defective by Buyers Products Co. Authorization from Buyers Products Co. must be obtained before returning any part. No charges for transportation or labor performed on Buyers' products will be allowed under this warranty.