

INSTALLATION MANUAL

60705

Level of Difficulty

Moderate

Installation difficulty levels are based on time and effort involved and may vary depending on the installer level of expertise, condition of the vehicle and proper tools and equipment.

Weight Carrying Capacity

Gross trailer weight (GTW)	40,000 lbs.
Tongue weight (TW)	10,000 lbs.

Parts List

Item	Qty	Description
1	1	Trailer hitch
2	1	Lock pin
3	1	Handle rod
4	1	2 5/16" ball
5	4	Hex bolt, 3/4" - 10 x 2", grade 8
6	4	Serrated-flange nut, 3/4" - 10
7	4	Flat washer, 3/4"
8	2	Square U-bolt, 5/8"
9	8	Flat washer, M16
10	4	U-bolt spring
11	4	Center lock nut, 5/8" - 18
12	1	Nylock nut, #10 - 24
13	1	Flange bolt, #10 - 24 x 1 1/4", grade 2
14	1	U-Edging (not shown)

Tools Required

Ratchet	Box-end wrench set
Socket extension, 6"	Torque wrench
Socket set	Pry bar
Rust inhibitor	Hole saw, 4"
Drill bit, 3/16"	Drill bit, 11/16"
Drill	

* For a tools reference guide visit curtmfg.com/trailer-hitch-installation

⚠ WARNING

Never exceed the vehicle manufacturer's recommended towing capacity.

Product Photo

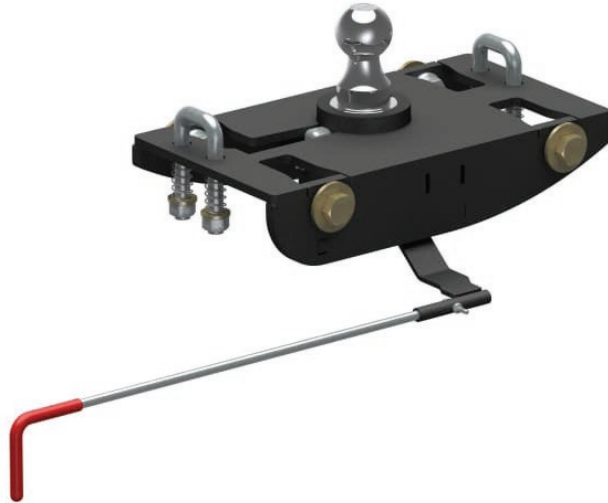

NOTICE

Visit www.curtmfg.com for a full-color copy of this instruction manual, as well as helpful videos, guides and much more!

Before you begin installation, read all instructions thoroughly.

Proper tools will improve the quality of installation and reduce the time required.

This installation requires:

- Temporarily lower spare tire and heat shield
- No frame drilling
- Handle may require adjustment

Periodic inspection of the trailer hitch should be performed to ensure all mounting hardware remains tight and structural components are secure.

To help prevent damage to the product or vehicle, refer to the specified torque specifications when securing hardware during the installation process.

SAFETY INSTRUCTIONS

Safety glasses and ear protection should be worn at all times while installing this product.

Product Registration and Warranty

CURT stands behind our products with industry-leading warranties. To get copies of the product warranties, register your purchase or provide feedback, visit: warranty.curtgroup.com/surveys

ASSEMBLY

Parts List

Item	Qty	Description
1	1	Trailer hitch
2	1	Lock pin
3	1	Handle rod
4	1	2 5/16" ball
5	4	Hex bolt, 3/4" - 10 x 2", grade 8
6	4	Serrated-flange nut, 3/4" - 10
7	4	Flat washer, 3/4"
8	2	Square U-bolt, 5/8"
9	8	Flat washer, M16
10	4	U-bolt spring
11	4	Center lock nut, 5/8" - 18
12	1	Nylock nut, #10 - 24
13	1	Flange bolt, #10 - 24 x 1 1/4", grade 2
14	1	U-Edging (not shown)

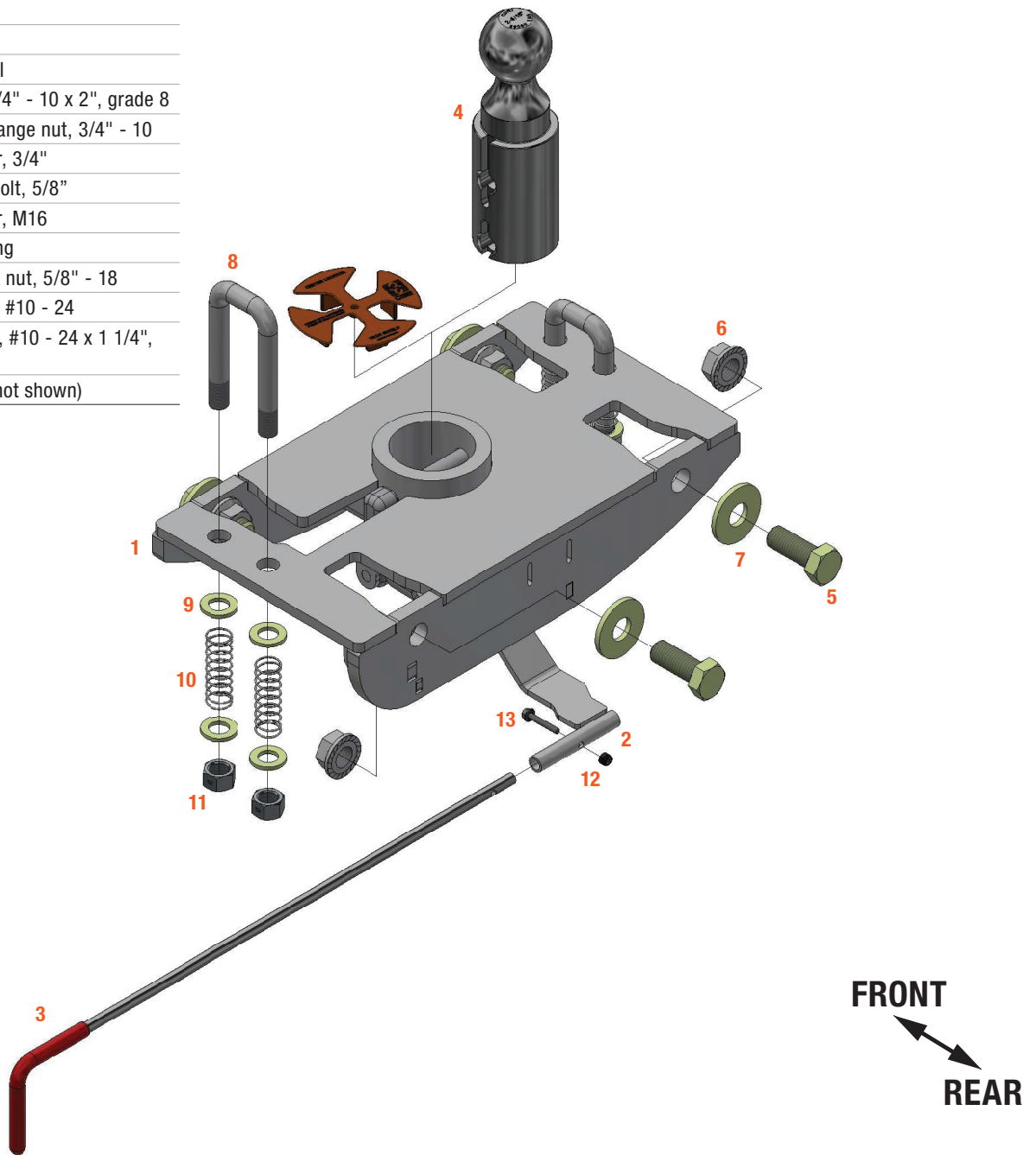

RUBBER ISOLATOR REMOVAL DIAGRAM

This technique can be used if exhaust hanger removal pliers are not available.

Using a 5/8" open end wrench, slide the wrench up to the rubber isolator, cradling the hanger rod as shown.

Place the flat edge of a pry bar between the wrench and the hanger stop or hanger rod. Then simply rotate the pry bar toward the wrench to remove the rubber isolator.

Note: Using a lubricant or soapy water on the hanger rod and the rubber isolator helps removal.

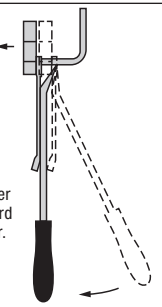

Step 1

Lower exhaust by removing the (3) rear most rubber exhaust hangers, see rubber isolator removal diagram.

Note: Removal of spare tire and spare tire heat shield may ease installation.

Step 2

From under the truck lift the gooseneck center section into position with the center locator installed and secure with 3/4-10 x 2" hex bolts, washers and hex flange nuts. Torque all 3/4" fasteners to 320 ft-lbs.

Note: The rear axle breather hose may need to be temporarily relocated prior to hitch installation.

Step 3

From under the truck drill a pilot hole through the center locator using a 3/16" drill bit. Using the safety chain holes in the gooseneck center section as a drill guide, drill (4) 11/16" holes up through the truck bed.

Note: Drilling a small pilot hole prior to the 11/16" hole will ease this process. Drill must be perpendicular to the cross member and bed.

Step 4

From inside the truck bed finish drilling the 4" hole, using the pilot hole as a guide.

Note: Use cutting fluid and cut slowly to ease this process. Deburr hole and spray exposed metal with rust inhibitor. Install supplied rubber U-edging if desired.

Step 5

Install U-bolts from inside the truck bed, ensure that they sit flat when in the lower position and slide easily without binding. Enlarge holes as needed for proper operation. Deburr holes and spray exposed metal with rust inhibitor.

Step 6

From under the truck place a washer (9), a spring (10), a washer (9), and a nut (11) on each of the four U-bolt legs. Tighten the nuts until flush with the bottom of the U-bolt.

Step 7

Pass the Handle rod through the 1" round hole in the driver side frame rail, just rear of the axle. Insert the Handle rod into the Linkage Arm tube and install the #10 flange bolt and #10 nylock nut.

Step 8

Snug all #10 fasteners and apply an automotive grade grease to Guide Slide and locking pin. Make sure that handle operates properly and the locking pin can be pulled out and locked out and then can re-engage with the cylinder. If needed, adjust either the handle or linkage arm 1/4" fasteners until operation is smooth.

Step 9

Reinstall exhaust hangers, heat shield and spare tire if removed in Step 1.

TOWING BASICS & SAFETY INFORMATION

For information on safely towing your trailer, visit curtmfg.com/understanding-towing.