

FRAME BRACKET 8552030

Dodge 1500 5-1/2', 6-1/2' & 8' Box No Air Suspension

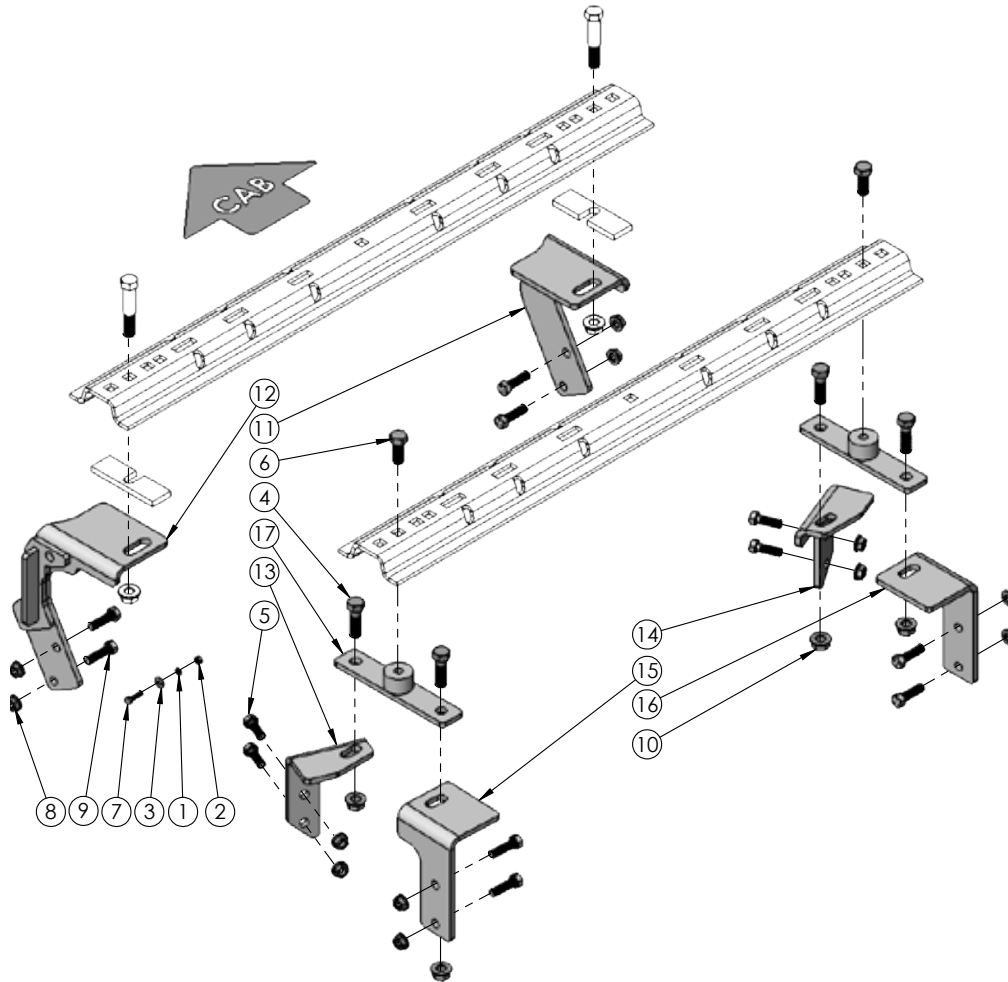

ITEM	PART #	QTY	DESCRIPTION
1	00057	1	WASHER, .25 SPRING LOCK
2	00062	1	NUT .25NC HEX
3	00214	1	WASHER, FLAT, .25
4	00290	4	BOLT .625NC X 2.00 GR5 HEX
5	01254	4	BOLT, .50 NC X 1.50 GR.5 HEX
6	04051	2	BOLT, .625 NC X 1.50 HEX HEAD
7	04055	1	.25-20NC X 1 GD5 HEX
8	10379	12	1/2" UNC FLANGED NUT
9	14266	8	.50NC X 1.75 KNURLED NECK
10	14340	4	5/8" UNF FLANGED WHEEL NUT

Please order replacement parts by PART NO. and DESCRIPTION.

ITEM	PART #	QTY	DESCRIPTION
11	14512-76	1	FRONT BRACKET PASSENGER
12	15397-76	1	DRIVER SIDE UL MTG BRKT
13	15785-76	1	MIDDLE DRIVER BRACKET
14	15786-76	1	MIDDLE PASSENGER BRACKET
15	15787-76	1	REAR DRIVER BRACKET
16	15788-76	1	REAR PASSENGER BRACKET
17	15789-76	2	REAR SPACER
-	14238	1	FISH WIRE 1/2" (NOT SHOWN)
-	12329	2	LOCTITE (NOT SHOWN)

Please order replacement parts by PART NO. and DESCRIPTION.

Installation

8552030 General Assembly & Installation Instructions

WARRANTY POLICY, OPERATOR MANUALS & REGISTRATION

Go online to www.demco-products.com to review Demco warranty policies, operator manuals and register your Demco product.

BOLT TORQUE SPECIFICATIONS

STANDARD BOLTS			METRIC BOLTS		
Size	Grade	Torque	Size	Grade	Torque
5/16"	5	18 ft/lbs.	8mm	8.8	23 ft/lbs.
3/8"	5	30 ft/lbs.	10mm	8.8	45 ft/lbs.
7/16"	5	50 ft/lbs.	12mm	8.8	78 ft/lbs.
1/2"	5	75 ft/lbs.	14mm	8.8	125 ft/lbs.
5/8"	5	150 ft/lbs.	16mm	8.8	160 ft/lbs.
3/4"	5	290 ft/lbs.			

CAUTION: Do not install base rails over plastic bed liners. Plastic bed liners must be cut out of the way. Rails may be installed on spray in liners.

NOTE: All metal surfaces that come in contact with the aluminum body need to have vinyl placed in between to prevent corrosion.

NOTE: Consult spray liner installer for recommended curing time.

1. Jack rear of truck up and remove tires.



3. Remove two screws from plastic trim behind each wheel as shown.



2. Remove two plastic push fasteners from bottom of box as shown in picture. **NOTE:** Not applicable on all models. Repeat on other side.



4. Remove remaining nine screws from each wheel well insert.



5. Bolt on rear spacer brackets on the end of one UL rail (bed rail) using 5/8" x 1 1/2" Gr.5 bolt. Apply included **LOCTITE**® to these bolts and tighten making sure that brackets are square with the UL rail. **NOTE:** Brackets bolt to the second hole from the end as displayed in above picture.. This rail will be the back rail you will measure to in the next step.

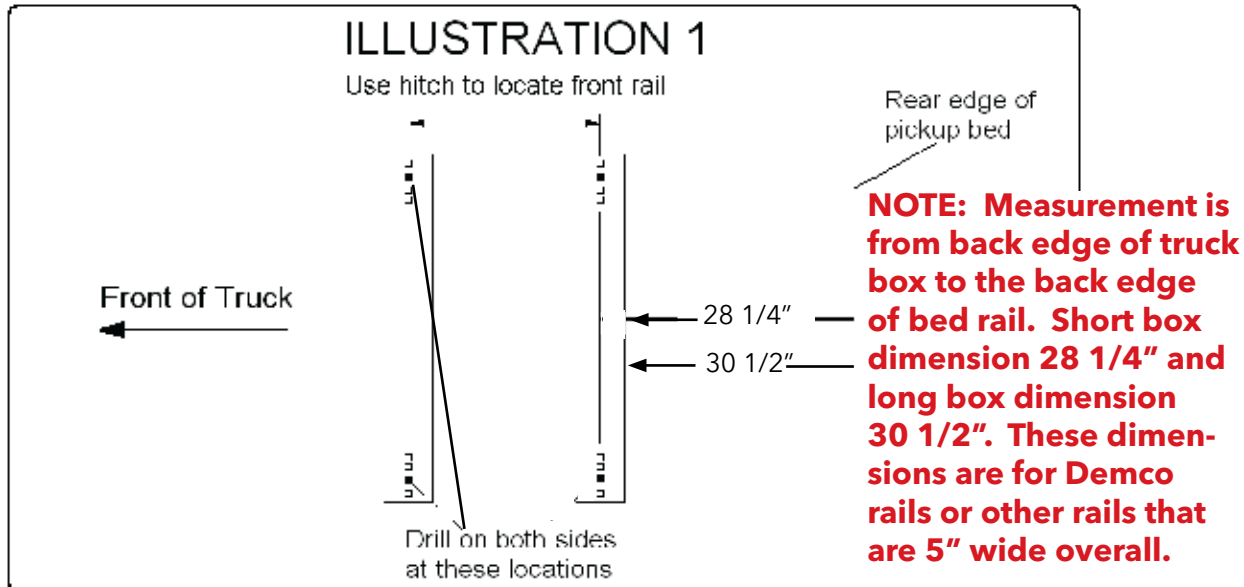

6. Fully assemble the 5th wheel hitch on a flat, level surface and pin into the base r (with hitch components). **Place assembled hitch in truck bed between the wheel wells, center it side to side and measure 28 1/4" from back edge of truck box to the back edge of bed rail for 5 1/2' & 6 1/2' boxes and 30 1/2" for 8' box.**
7. First check for obstructions under box, then drill 5/8" holes thru the second square hole from the end of front rail and two holes on each side of rear rail brackets that were bolted in step 5.

Installation

- Put 3 1/2" bolts in front rail and 5/8" x 2" Gr.5 bolts into rear rail brackets; two on each side.



- Slide rear frame brackets over to 2" bolt and use 5/8" serrated head nut. Clamp bracket to frame loosely and tighten bolt from above. **NOTE:** Some models have ground stud located on drivers side where rear frame bracket mounts. Remove wire and grind stud off of frame. Make sure wiring is behind frame bracket and relocate wire terminal by using 1/4" x 1" bolt, 1/4" flat washer, 1/4" lockwasher and 1/4" hex nut. Use frame access hole to install bolt. **NOTE:** Sand or grind paint off of frame before installing ground terminal.



- Repeat above directions for middle frame bracket. Clamp loosely to coil tower framework and tighten.

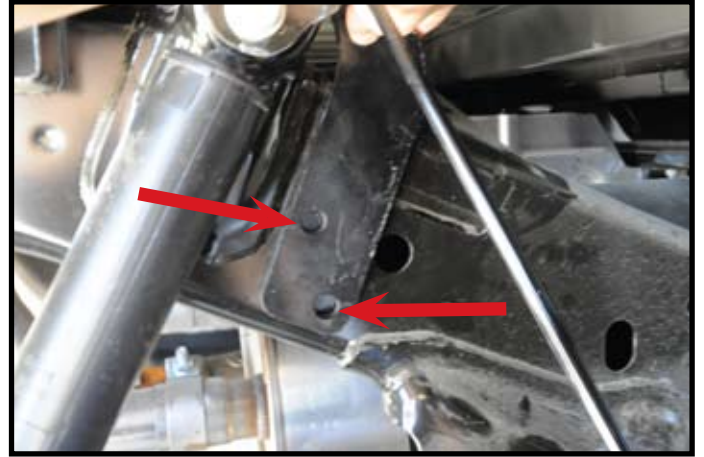

- Slide front frame brackets to outside of frame and mount front bed rail while keeping frame bracket tight to frame. Tighten all bed rail bolts according to chart on front page. Passenger side shown.
- On drivers side, loosen or remove brace rod so front frame bracket can be installed. If equipped with gas engine, remove wiring holders so frame bracket can lay flat to frame.
- Using the holes in the frame brackets, drill 17/32" holes in the side of the frame and coil tower. The front frame brackets and the rear frame brackets will then be attached using 1/2" x 1 3/4" hex knurled bolts and flange nuts, that are fished through an access hole in the frame using fish wire provided in the kit. The middle bracket will use 1/2" x 1 1/2" Gr.5 bolt and 1/2" washer and 1/2" serrated head nut.. Tighten all frame bracket bolts according to the chart on front page. Passenger front bracket shown.



- Completed install.

1. Place the template in the box and center the template between the wheel wells.
2. **IF NEEDED, TAPE THE TEMPLATE DOWN.**
3. Measure from the back of the box to the template on the passengers side and drivers side to insure that the template is square. See **DRAWING #1** and table for measurements.
4. Locate which holes you will be drilling, by the ones marked with a red arrow.
5. Take a 3/8" locating punch and mark the holes to be drilled.
6. **BEFORE YOU DRILL, MAKE SURE THAT THE TEMPLATE DID NOT MOVE, AND THAT THERE ARE NO OBSTRUCTIONS IN THE WAY.**
7. Remove the template and drill the four marked holes with a 5/8" drill bit.
NOTE: A pilot hole may need to be drilled.
8. Deburr each hole.
9. Touch up the bare metal with some paint that matches the box of the truck.

Installation

Truck Bed Drilling Instructions with Template

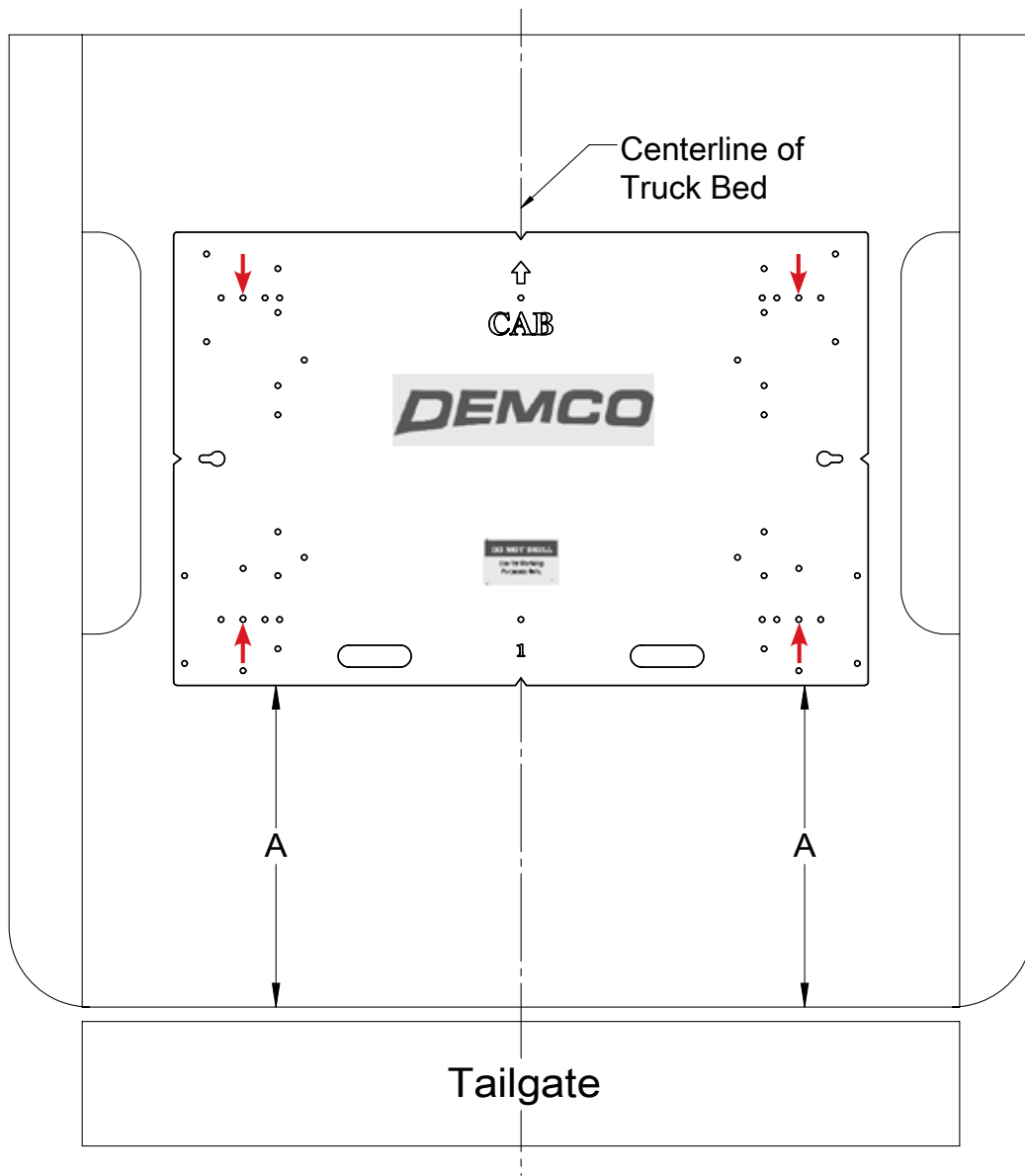

Drawing #1

BOX LENGTH	DIMENSIONS	MEASUREMENT
DODGE 1500 (NO AIR SUSPENSION)		
5-1/2'	A	*23-3/4"
6-1/2'	A	*23-3/4"
8'	A	*26"
*ALL MEASUREMENTS ARE FROM THE BACK OF THE BOX		

DEMCO

4010 320th St., Boyden, IA. 51234

Phone: (712) 725-2311

Fax: (712) 725-2380

Toll Free: 1-800-54DEMCO (1-800-543-3626)

**Demco warranty policies, operator manuals, and product registration
can be found online:**

www.demco-products.com

