

FRAME BRACKET 8552032

Dodge 1500 (5-1/2', 6-1/2' & 8' Boxes) No Air Suspension

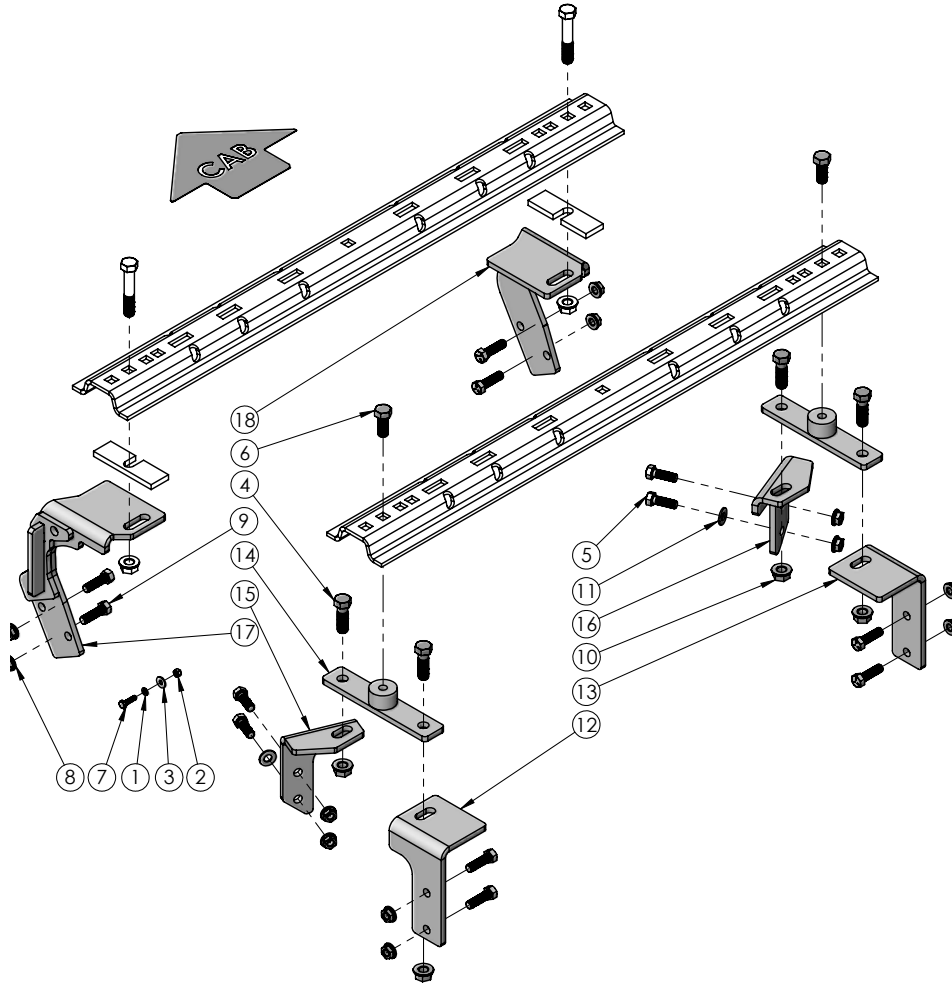

| ITEM | PART # | QTY | DESCRIPTION |
|------|--------|-----|-------------------------------|
| 1 | 00057 | 1 | WASHER, .25 SPRING LOCK |
| 2 | 00062 | 1 | NUT .25NC HEX |
| 3 | 00214 | 1 | WASHER, FLAT, .25 |
| 4 | 00290 | 4 | BOLT .625NC X 2.00 GR5 HEX |
| 5 | 01254 | 4 | BOLT, .50 NC X 1.50 GR.5 HEX |
| 6 | 04051 | 2 | BOLT, .625 NC X 1.50 HEX HEAD |
| 7 | 04055 | 1 | .25-20NC X 1 GD5 HEX |
| 8 | 10379 | 12 | 1/2" UNC FLANGED NUT |
| 9 | 14266 | 8 | .50NC X 1.75 HEX KNURLED NECK |
| 10 | 14340 | 4 | 5/8" UNF FLANGED WHEEL NUT |

Please order replacement parts by PART NO. and DESCRIPTION.

| ITEM | PART # | QTY | DESCRIPTION |
|------|----------|-----|----------------------------|
| 11 | 14488 | 2 | .50 FLAT WASHER NARROW RIM |
| 12 | 15787-76 | 1 | REAR DIVER BRACKET |
| 13 | 15788-76 | 1 | REAR PASS BRACKET |
| 14 | 15789-76 | 2 | REAR SPACER |
| 15 | 16630-76 | 1 | MIDDLE BRACKET, DRIVER |
| 16 | 16631-76 | 1 | MIDDLE BRACKET, PASSENGER |
| 17 | 16632-76 | 1 | UL MTG BRACKET, DRIVER |
| 18 | 16633-76 | 1 | FRONT BRACKET PASSENGER |
| - | 14238 | 1 | FISH WIRE 1/2" (NOT SHOWN) |
| - | 12329 | 2 | LOCTITE (NOT SHOWN) |

Please order replacement parts by PART NO. and DESCRIPTION.

Introduction

8552032 General Assembly & Installation Instructions

WARRANTY POLICY, OPERATOR MANUALS & REGISTRATION

Go online to www.demco-products.com to review Demco warranty policies, operator manuals and register your Demco product.

BOLT TORQUE SPECIFICATIONS

| STANDARD BOLTS | | | METRIC BOLTS | | |
|----------------|-------|-------------|--------------|-------|-------------|
| Size | Grade | Torque | Size | Grade | Torque |
| 5/16" | 5 | 18 ft/lbs. | 8mm | 8.8 | 23 ft/lbs. |
| 3/8" | 5 | 30 ft/lbs. | 10mm | 8.8 | 45 ft/lbs. |
| 7/16" | 5 | 50 ft/lbs. | 12mm | 8.8 | 78 ft/lbs. |
| 1/2" | 5 | 75 ft/lbs. | 14mm | 8.8 | 125 ft/lbs. |
| 5/8" | 5 | 150 ft/lbs. | 16mm | 8.8 | 160 ft/lbs. |
| 3/4" | 5 | 290 ft/lbs. | | | |

CAUTION: Do not install base rails over plastic bed liners. Plastic bed liners must be cut out of the way. Rails may be installed on spray in liners.

NOTE: All metal surfaces that come in contact with the aluminum body need to have vinyl placed in between to prevent corrosion.

NOTE: Consult spray liner installer for recommended curing time.



1. Remove the rear tires by either placing the truck on a hoist, or jacking the rear up.



3. Bolt on rear spacer brackets on the end of one UL rail (bed rail) using 5/8" x 1 1/2" Gr.5 bolt. Apply included **LOCTITE**® to these bolts and tighten making sure that brackets are square with the UL rail. **NOTE:** Brackets bolt to the second hole from the end as displayed in above picture. This rail will be the back rail you will measure to in the next step.



2. Remove both wheel well liners by removing 12 screws from the inside of each rear wheel.

- 4a. Fully assemble the 5th wheel hitch on a flat, level surface and pin into the base rails (assembly instructions come with hitch components).

- 4b. Place assembled hitch in truck bed between the wheel wells, center it side to side and measure 28 1/4" from back edge of truck box to the back edge of bed rail for 5 1/2' & 6 1/2' boxes and 30 1/2" for 8' box. See Illustration #1 on the next page.



5. Unplug the two drivers side wiring harness plug-ins. Loosen the large harness from the anchored locations in the frame and crossmember. Temporarily remove the ground wire nut. Move the harness out of the way for the holes to be drilled.

NOTE: Raising the box may aid in the unplugging and moving of the wires.

HIGH IMPORTANCE! BEFORE ANY DRILLING IS DONE. MAKE SURE, THERE ARE NO OBSTRUCTIONS UNDER THE BOX!



- 6a. Remove the nut from the grounding stud ahead of the drivers side shock.
- 6b. Grind the stud off so that the drivers side front bracket can lay flat to the frame.
- 6c. Sand or grind the paint off of the frame before installing the ground terminal.
- 6d. Relocate the ground wire as shown in the picture above. Drill a 1/4" hole and use a 1/4" bolt, flat washer, lock washer, and nut supplied to you by Demco.

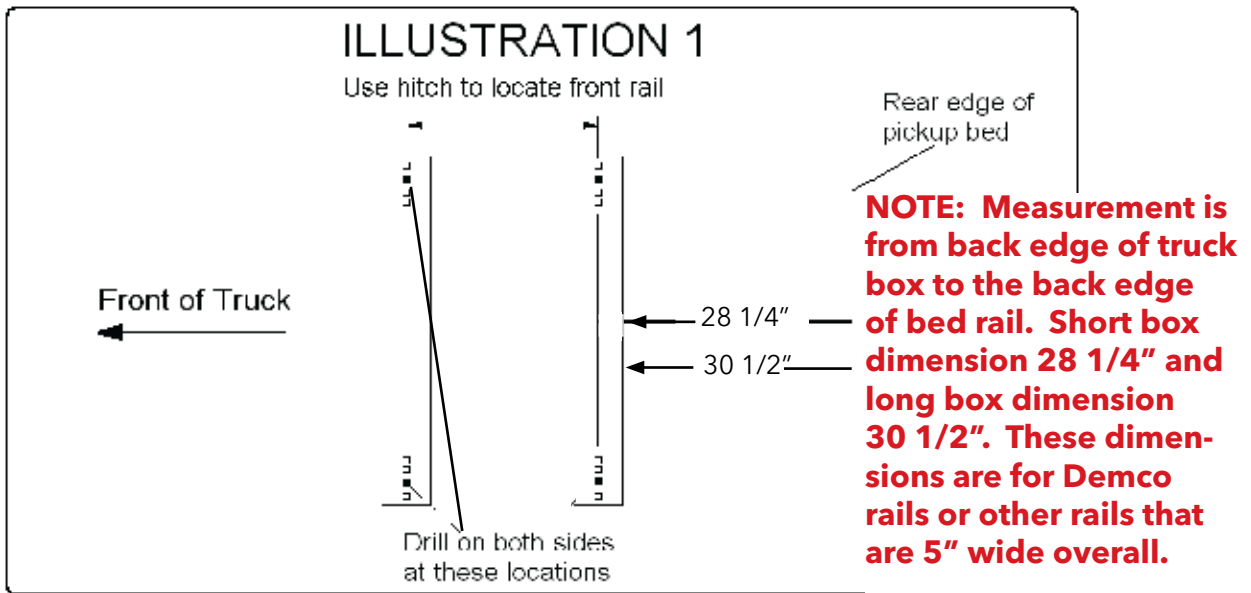

7. Drill 5/8" holes thru the second square hole from the end of front rail and two holes on each side of rear rail brackets that were bolted in step 3.



- 8a. Slide both rear frame brackets over to the 2" bolts from above, lineup the slot with the bolt and snug up the 5/8" serrated head nuts onto the frame bracket.
- 8b. Clamp the brackets to the frame and push them tight to the box floor. Tighten these bolts. Picture is taken from the passengers side rear.



9. Repeat steps 8a and 8b with the middle frame bracket. Passenger side is shown.



10a. Slide both front frame brackets over to the 3-1/2" bolts from above, lineup the slot with the bolt and snug up the 5/8" serrated head nuts onto the frame bracket.

10b. Clamp the brackets to the frame and push them tight to the box floor. Tighten these bolts. Picture is taken from the passengers side front.

NOTE: If equipped with a gas engine remove wiring holders so that the frame bracket can lay flat to the frame. On drivers side.

11. Using the holes in the frame brackets, drill 17/32" holes in the side of the frame and coil tower. The front frame brackets and the rear frame brackets will then be attached using 1/2" x 1 3/4" hex knurled bolts and flange nuts, that are fished through an access hole in the frame using fish wire provided in the kit. The middle bracket will use 1/2" x 1 1/2" Gr.5 bolt, and 1/2" serrated head nut. . Tighten all frame bracket bolts according to the chart on front page.

NOTE: Both middle coil tower brackets may already have a hole in them at the bottom of the brackets. If so, us the 1/2" washer with a 1/2" bolt included in the kit, make sure the bolt is from the inside pointing out.



12. Completed install.

Installation

Truck Bed Drilling Instructions with Template

1. Place the template in the box and center the template between the wheel wells.
2. **IF NEEDED, TAPE THE TEMPLATE DOWN.**
3. Measure from the back of the box to the template on the passengers side and drivers side to insure that the template is square. See **DRAWING #1** and table for measurements.
4. Locate which holes you will be drilling, by the ones marked with a red arrow.
5. Take a 3/8" locating punch and mark the holes to be drilled.
6. **BEFORE YOU DRILL, MAKE SURE THAT THE TEMPLATE DID NOT MOVE, AND THAT THERE ARE NO OBSTRUCTIONS IN THE WAY.**
7. Remove the template and drill the four marked holes with a 5/8" drill bit.
NOTE: A pilot hole may need to be drilled.
8. Deburr each hole.
9. Touch up the bare metal with some paint that matches the box of the truck.

Truck Bed Drilling Instructions with Template

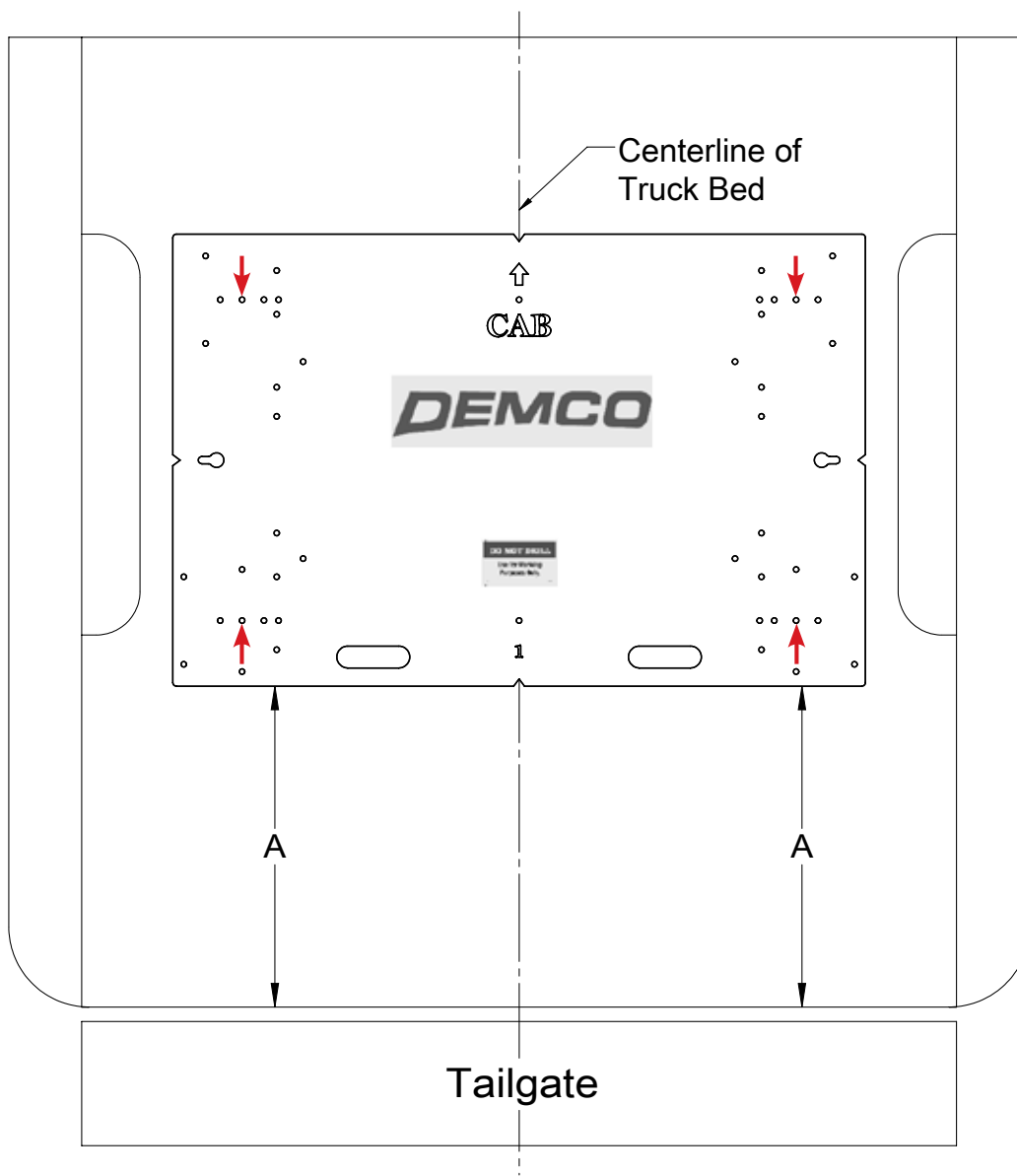

Drawing #1

| BOX LENGTH | DIMENSIONS | MEASUREMENT |
|--|------------|-------------|
| DODGE 1500 (NO AIR SUSPENSION) | | |
| 5-1/2' | A | *23-3/4" |
| 6-1/2' | A | *23-3/4" |
| 8' | A | *26" |
| *ALL MEASUREMENTS ARE FROM THE BACK OF THE BOX | | |

DEMCO

4010 320th St., Boyden, IA. 51234

Phone: (712) 725-2311

Fax: (712) 725-2380

Toll Free: 1-800-54DEMCO (1-800-543-3626)

**Demco warranty policies, operator manuals, and product registration
can be found online:**

www.demco-products.com

