



Chevrolet/GMC
Silverado & Sierra
2500 & 3500HD
6 1/2' & 8' Box

02/18
HJ33007, Rev 4



BOLT TORQUE SPECIFICATIONS

STANDARD BOLTS			METRIC BOLTS		
Size	Grade	Torque	Size	Grade	Torque
5/16"	5	18 ft/lbs.	8mm	8.8	23 ft/lbs.
3/8"	5	30 ft/lbs.	10mm	8.8	45 ft/lbs.
7/16"	5	50 ft/lbs.	12mm	8.8	78 ft/lbs.
1/2"	5	75 ft/lbs.	14mm	8.8	125 ft/lbs.
5/8"	5	150 ft/lbs.	16mm	8.8	160 ft/lbs.
3/4"	5	290 ft/lbs.			

FRAME BRACKET

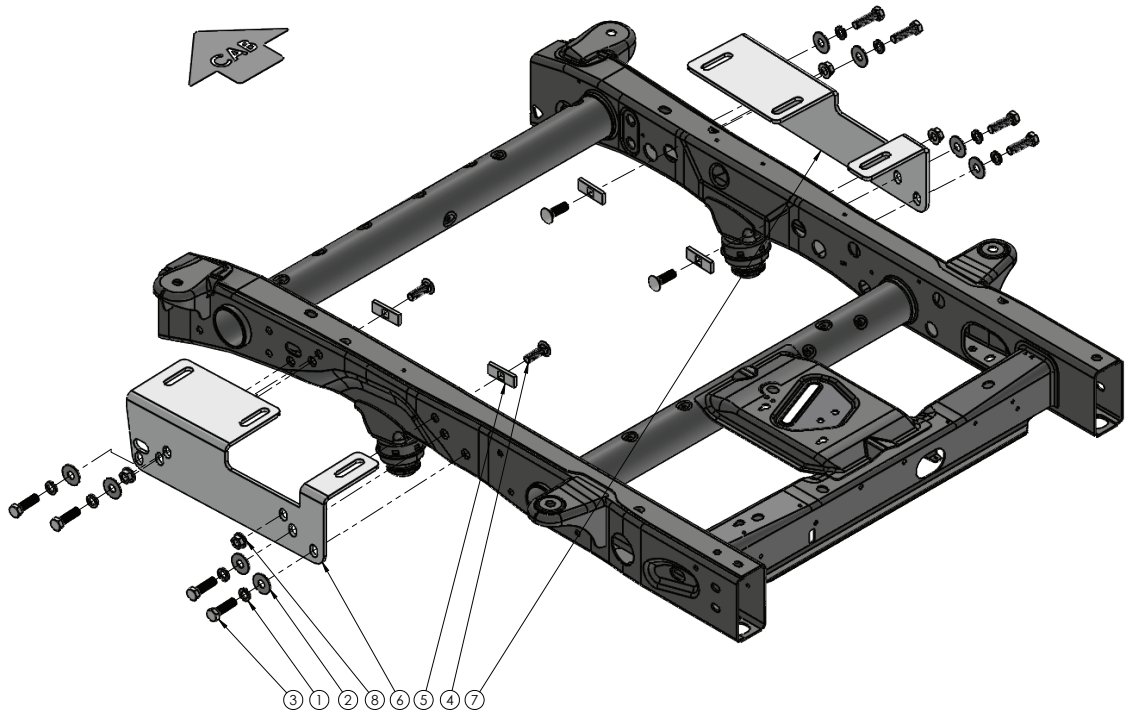

8553007 PARTS LIST

ITEM	PART #	QTY.	DESCRIPTION
1	00248	8	WASHER SPRING LOCK 0.625
2	00477	8	WASHER, FLAT, .625
3	07608	8	BOLT, 16MM - 2.00 x 55MM GR10.9 HEX
4	10572	4	BOLT, .625 X 2.00 GR5 CARRIAGE
5	14158-76	4	CARR. BOLT PLATE
6	14166-76	1	FRAME BRACKET DRIVER
7	14167-76	1	FRAME BRACKET PASSENGER
8	14340	4	5/8" UNF FLANGED WHEEL NUT
9	14210	1	5/8" FISH WIRE (NOT SHOWN)
10	12329	-	LOCTITE (NOT SHOWN)

Please order replacement parts by PART NO. and DESCRIPTION.

ASSEMBLY
OPERATION
REPLACEMENT PARTS

READ complete manual CAREFULLY
BEFORE attempting operation.

Doing Our Best to Provide You the Best

WARRANTY POLICY, OPERATOR MANUALS & REGISTRATION

Go online to www.demco-products.com to review Demco warranty policies, operator manuals and register your Demco product.

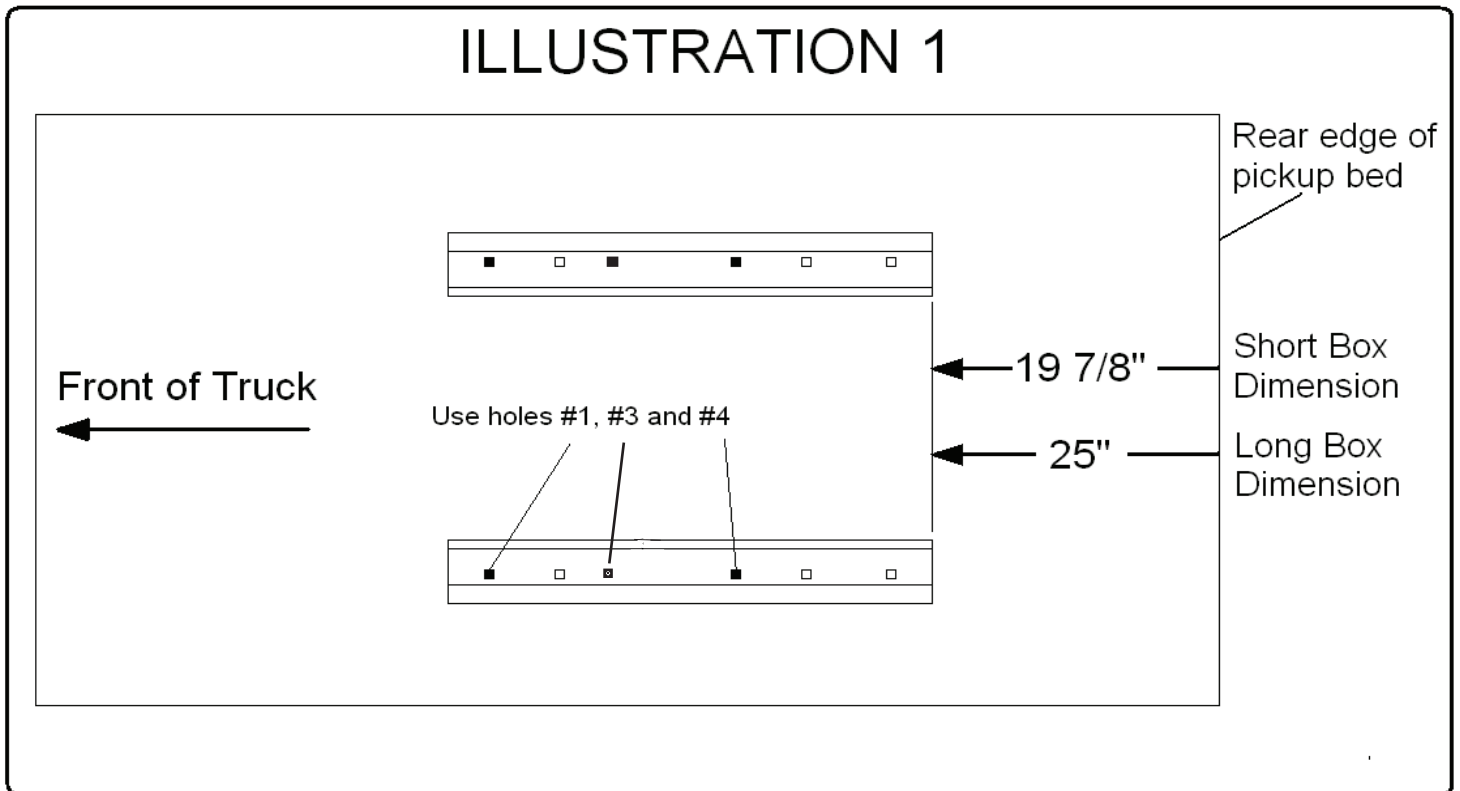

CAUTION: Do not install base rails over plastic bed liners. Plastic bed liners must be cut out of the way. Rails may be installed on spray in liners.

NOTE: Consult spray liner installer for recommended curing time.

1. Fully assemble the 5th wheel hitch on a flat, level surface and pin into the base rails (assembly instructions come with hitch components). Place assembled hitch in truck bed between the wheel wells, center it side to side and measure from back edge of truck box to back edge of bed rail. See Illustration 1 above.
2. First check for obstruction under box, then drill two 17/32" holes thru hole #1 in each bed rail. Insert two 1/2" x 3" (04073) long hex bolts and 1/2" (07490) flat washers.
3. Lift up spring loaded locking pins and slide hitch back to rear most set of holes and lock into place. This will help to align base rails so they remain square for best operation. Drill thru hole #4 of each bed rail and insert two 1/2" x 3" (04073) long hex bolts and 1/2" (07490) flat washers, then do the same for hole #3 of each bed rail.
4. Position the left (14166-76) and right (14167-76) frame brackets up against the outer surface of the truck frame with the mounting tabs positioned over the frame and under the bed in line with the previously drilled holes in the bed where the 1/2" x 3" (04073) bolts are coming down through the bed.
5. Make sure the frame brackets are tight against the flat side of the truck frame and underneath the surface of the truck bed with bolts extending down through slotted holes in frame bracket tabs. Loosely fasten bolts with 3/16" spacer plates (14283-95) and 1/2" serrated flange hex nut.

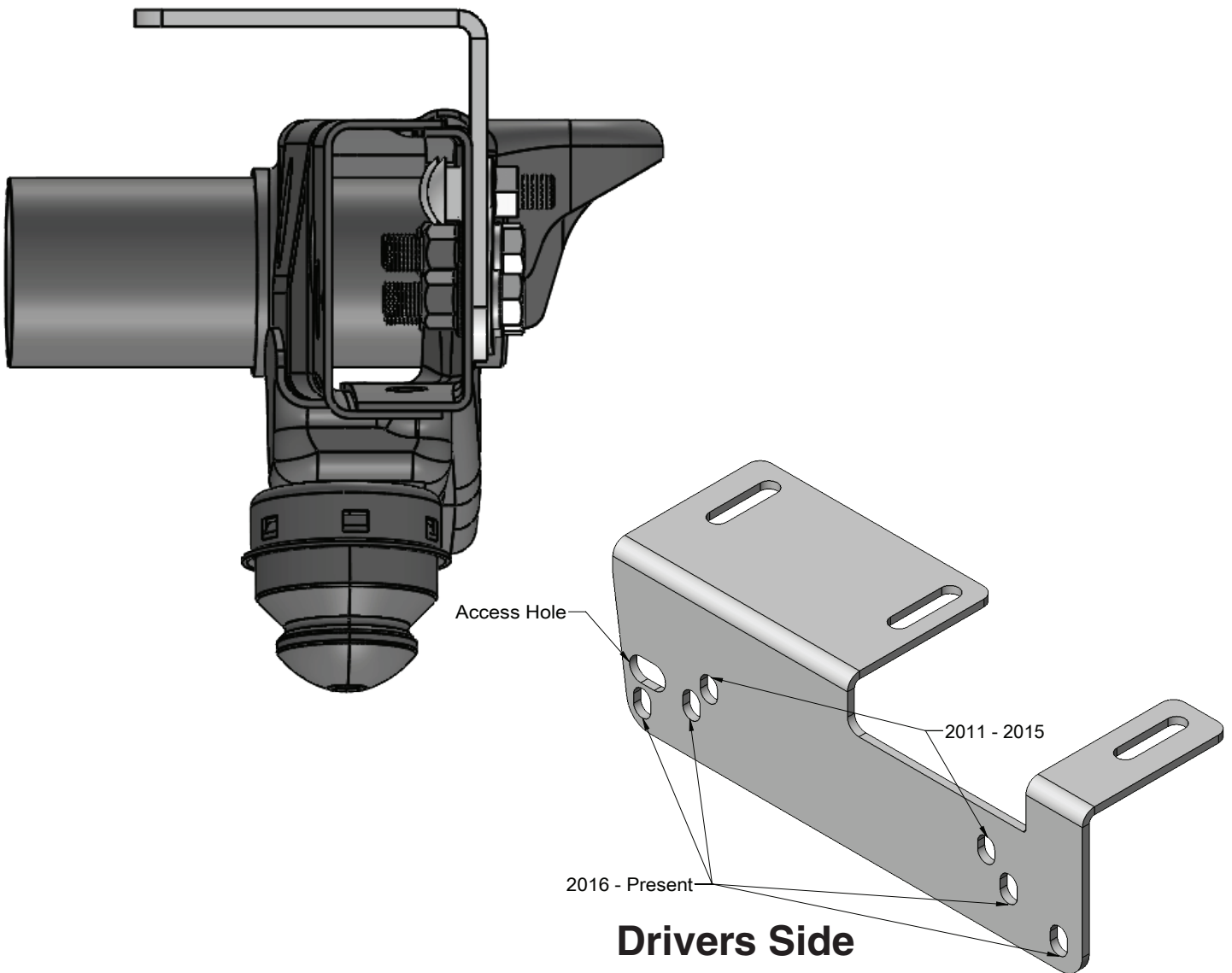

2011 - 2015

- Each of the frame brackets must be attached to the side frame of the truck with a 5/8" x 2" carriage bolt (10572) and washer plate (14158-76) from the inside of the frame fished through an access hole in the frame using the fish wire provided in the kit. Use 5/8" flange nuts (14340) on the outside of the frame bracket. See Illustration 3.
- Tighten all bolts according to chart on front page. Failure to tighten bolts as described may result in fastener loss or failure.

2016 - Present

- Each of the frame brackets will be attached to the side of the frame to the trucks, using the factory threaded holes in the frame. Use four 16mm x 55mm bolts and 5/8" lockwashers and 5/8" flat washers on each side. **NOTE:** The threaded holes in the frame may need to be cleaned.
- Tighten all bolts according to chart on front page. Failure to tighten bolts as described may result in fastener loss or failure.

Demco

4010 320th St., BOYDEN, IA. 51234

PH: (712) 725-2311

FAX: (712) 725-2380

TOLL FREE: 1-800-54DEMCO (1-800-543-3626)

www.demco-products.com

Go online to www.demco-products.com for Demco warranty policies, operator manuals & product registration.