

7,200 lb Capacity Per Axle

Dexter® 12-1/4" x 2-1/2" 7.2K Electric Brake
Use with 8 - Bolt 12-1/4" x 2-1/2" Hubs & Drums

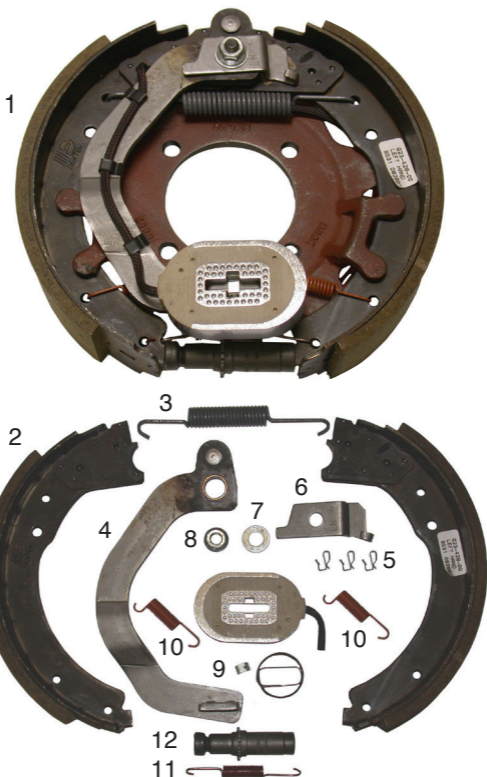

I.D.	Part No.	Qty. Req.	Description	Wt. Lb
(1)	23428	1	LH Complete brake assembly (shown)	16
1	23429	1	RH Complete brake assembly	16
Replacement Parts				
(2)	71-497	1	Left hand shoe & lining kit (shown)	
2	71-496	1	Right hand shoe & lining kit	
3	46-119	1	Shoe return spring (grey)	
(4)	47-124-5	1	Left hand actuating arm assembly (shown)	
4	47-125-5	1	Right hand actuating arm assembly	
5	27-39	3	Wire clip	
(6)	71-455-1	1	Left hand lever arm retainer (shown)	
6	71-455-2	1	Right hand lever arm retainer	
7	5-142	1	Washer	
8	6-92-1	1	Flange nut	
9	71-441	1	Magnet kit (red wires)	
10	46-136	2	Centering spring	
11	46-18	1	Adjuster spring	
12	48-17	1	Adjuster only	
-	36-118-20*	1	Dust shield (sold separately)	
	K850		Brake mounting kit (4-bolt/nut/washer)	

* Not included with complete brake assembly. Items sold separately.