

# 3,500 lb Capacity Per Axle

Dexter® 10" x 2-1/4" Free Backing Brake  
Use with 545UHI thru 655UHI Hubs & Drums

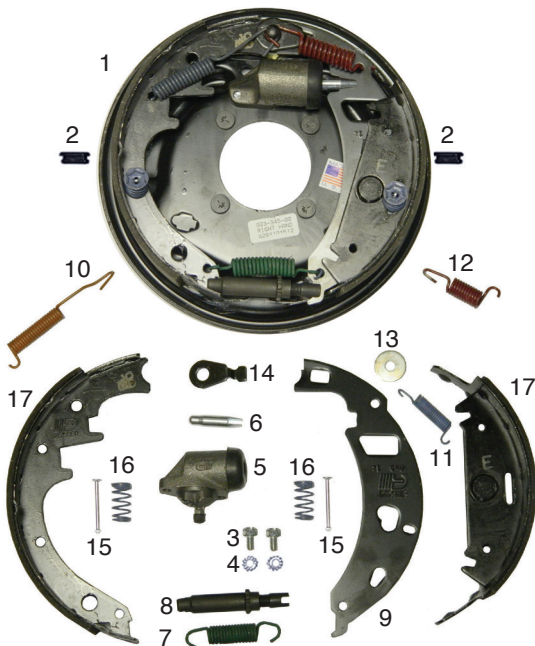

I.D.	Part No.	Qty. Req.	Description	Wt. Lb
	<b>23-3410*</b>		Pair 10" Free backing brakes	21
(1)	<b>23-344</b>		Left hand hydraulic brake complete	10
1	<b>23-345</b>	(shown)	Right hand hydraulic brake complete	10
<b>Replacement Parts</b>				
2	<b>467</b>	2	Adjuster hole plug	
3	<b>B51605G5ZC</b>	2	5/16"-18 x 1/2" Hex head bolt gr. 5	
4	<b>05424X</b>	2	5/16" External tooth washer	
(5)	<b>1907</b>	1	Wheel cylinder assembly - right (shown)	
5	<b>1906</b>	1	Wheel cylinder assembly - left	
6	<b>SB9783</b>	1	Push rod	
7	<b>46-83-1</b>	1	Adjuster spring	
8	<b>43-4</b>	1	Adjuster screw assembly	
9	<b>40-240</b>	1	Shoe lever	
10	<b>310</b>	1	Retractor spring	
11	<b>46-108</b>	1	Spring - lever	
12	<b>46-107</b>	1	Spring - lever	
13	<b>5-64</b>	1	Washer	
14	<b>37-69</b>	1	Travel link	
15	<b>10959</b>	2	Shoe hold-down pin (#8)	
16	<b>46-77</b>	2	Shoe hold-down spring (blue)	
17	<b>71393</b>		Shoe & lining kit - freebacking 10" x 2-1/4" Dexter® (1brake)	
	<b>4-7161G5</b>		Brake mounting kit (4-bolt/nut/washer)	

\* Pair includes mounting hardware. *Line kits - see page 118.*