

7,000 lb Capacity Per Axle

Dexter® 12" x 2" Free Backing Hydraulic Brake Use with 12" Hubs & Drums

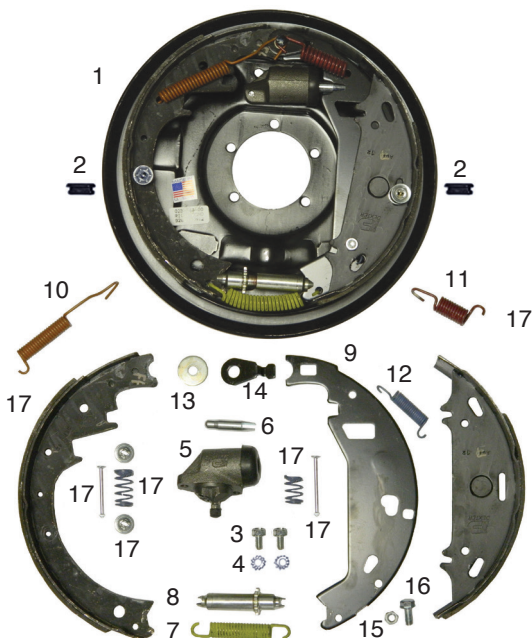

| I.D. | Part No. | Qty. Req. | Description | Wt. Lb |
|--------------------------|---------------------|-----------|---|--------|
| | 23-3412* | | Pair 12" Free backing hydra. brakes | 31 |
| (1) | 23-343 | (shown) | Right hand hydraulic brake complete | 15 |
| 1 | 23-342 | | Left hand hydraulic brake complete | 15 |
| Replacement Parts | | | | |
| 2 | 467 | 2 | Adjuster hole plug | |
| 3 | B5160625G5ZC | 3 | 5/16"-18 x 5/8" Hex head bolt gr. 5 | |
| 4 | 05424X | 2 | 5/16" External tooth washer | |
| (5) | 1907 | 1 | Wheel cylinder assembly - right (shown) | |
| 5 | 1906 | 1 | Wheel cylinder assembly - left | |
| 6 | SB9783 | 1 | Push rod | |
| 7 | 46-123 | 1 | Adjuster spring | |
| 8 | 43-28 | 1 | Adjuster screw assembly | |
| 9 | 40-244 | 1 | Shoe lever | |
| 10 | 100-092 | 1 | Spring - shoe | |
| 11 | 46-107 | 1 | Spring - lever | |
| 12 | 46-108 | 1 | Spring - shoe return | |
| 13 | 5-64 | 1 | Anchor post washer | |
| 14 | 37-69 | 1 | Travel link | |
| 15 | LN516G2ZC | 1 | 5/16"-18 Lock nut | |
| 16 | B516075G5ZC | 1 | 5/16"-18 x 3/4" Hex head bolt gr. 5 | |
| 17 | 71394 | | Shoe & lining kit LH - freebacking 12" x 2" Dexter® Includes hold down parts | |
| 17 | 71395 | | Shoe & lining kit RH - freebacking 12" x 2" Dexter® Includes hold down parts (shown) | |
| | 5-381G5 | | Brake mounting kit (5-nut/bolt/washer) | |

* Pair includes mounting hardware. *Line kits - see page 116.*