

9,000 - 10,000 lb Capacity Per Axle

Dexter® 12-1/4" x 3-3/8" General Duty
7 Bolt Mounting

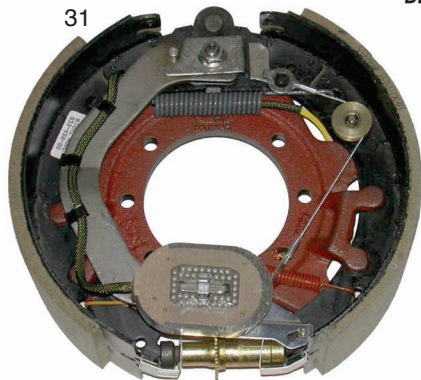

23-450

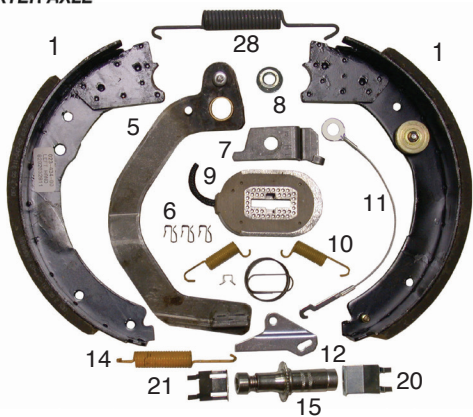

Description	9-10,000 lb GENERAL DUTY		
	I.D.	Part No.	Qty. Req. Wt. lb
Shoe Size & No. of Mounting Bolts	12-1/4" x 3-3/8" - 7		
LH Complete brake assembly	(31)	23-450	(shown) 18
RH Complete brake assembly	31	23-451	18
Replacement Parts			
LH Shoe & lining kit	1	71-499	1
RH Shoe & lining kit	1	71-498	1
Magnet kit (includes spring & clip)	9	71-376	1
Brake mounting bolt	-	B716175G5ZF	7
Brake mounting nut	-	HN716G5ZF	7
Brake mounting lock washer	-	LW716Z	7
Dust shield (sold separately)	-	36-115-21	1
Backing plate assembly	-	36-120-02	1

I.D.	Part No.	Qty. Req	Description
5	47-123-38	1	LH Actuator arm
5	47-123-37	1	RH Actuator arm
6	27-39	3	Wire clip
7	71-455-1	1	LH Arm/shoe retainer
7	71-455-2	1	RH Arm/shoe retainer
8	6-92-1	1	Flange nut
10	46-136	2	Centering spring
11	71-462	1	Adjuster cable
12	71-464	1	LH Adjuster lever
12	71-463	1	RH Adjuster lever
14	46-137	1	Adjuster spring
15	48-19	1	LH Adjuster assembly
15	48-20	1	RH Adjuster assembly
20	46-132	1	Adjuster clip (thread end)
21	46-133	1	Adjuster clip (barrel end)
28	46-119	1	Return spring