

# 3,500 lb Capacity Per Axle

Dexter® 10" x 2-1/4" Nev-R-Adjust® Electric Brake  
Use with 545UHI thru 655UHI Hubs & Drums

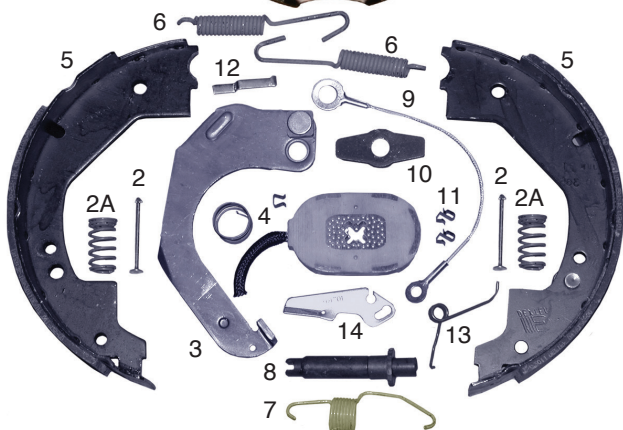

**Nev-R-Adjust®**

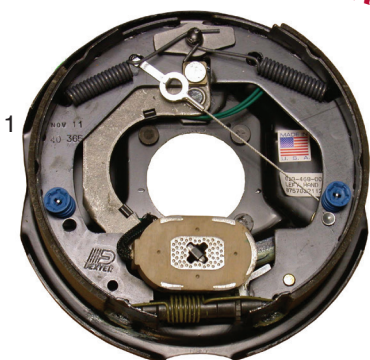

I.D.	Part No.	Qty. Req.	Description	Wt. Lb
	<b>23-4610*</b>		Pair 10" Nev-R-Adjust® electric brakes	23
1	<b>23-469</b>		Right hand electric brake complete	11
(1)	<b>23-468</b> (shown)		Left hand electric brake complete	11
<b>Replacement Parts</b>				
2	<b>10959</b>	2	Shoe hold-down pin (#8)	
2A	<b>46-77</b>	2	Shoe hold-down spring (blue)	
3	<b>354</b>	1	Right hand actuating lever	
(3)	<b>355</b>	1	Left hand actuating lever (shown)	
4	<b>103</b>	1	Magnet, spring & clip (green wires)	
(5)	<b>71-681**</b>	1	Left hand shoe & lining kit for 1 brake (shown)	
5	<b>71-682**</b>	1	Right hand shoe & lining kit for 1 brake	
6	<b>310</b>	2	Dual retractor springs	
	<b>71-703</b>	1	Left & right hand brake adjuster kit (includes 2 ea.: # 7,8,9,12,13 & 14)	
7	<b>46-139</b>	1	Adjuster spring	
(8)	<b>48-22</b>	1	Left hand adjuster only (shown)	
8	<b>48-23</b>	1	Right hand adjuster only	
	<b>467</b>	1	Adjuster hole plug	
10	<b>567</b>	1	Anchor post washer	
11	<b>275</b>	2	Wire clip for magnet wires	
	<b>4-7161G5</b>		Brake mounting kit (4-bolt/nut/washer)	

\* Pair includes mounting hardware.

\*\* **71-681** & **76-682** - shoe & lining kit, includes **10959** & **46-77** hold-down pins & springs.